



GT350 STYLE CHIN SPOILER

(2015-2017 MUSTANG GT, ECOBOOST, V6)

INSTALLATION INSTRUCTIONS

CONTENTS

(1) Chin Spoiler

TOOLS REQUIRED

7mm Socket & Ratchet/Drill
Flat Head Screw Driver

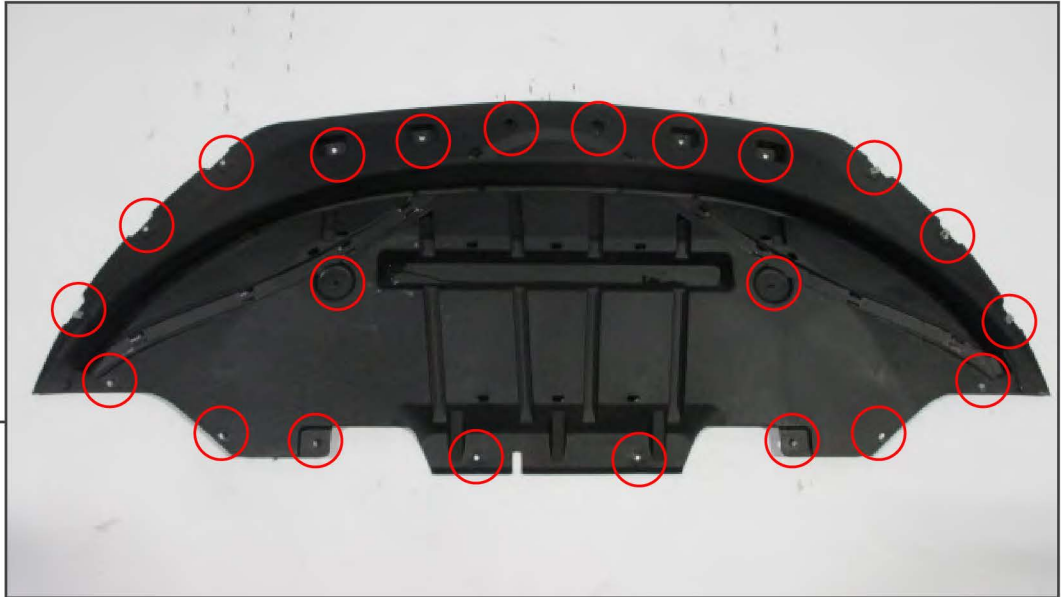

STEP 1

Support the front of the vehicle so you can access the bumper splash shield. Non-Performance Pack and Performance Pack equipped vehicles have slightly different splash shields, but are attached similarly using 7mm bolts and plastic push clips.



STEP 2

Remove the 7mm bolts and plastic push clips holding the chin spoiler to the bumper.

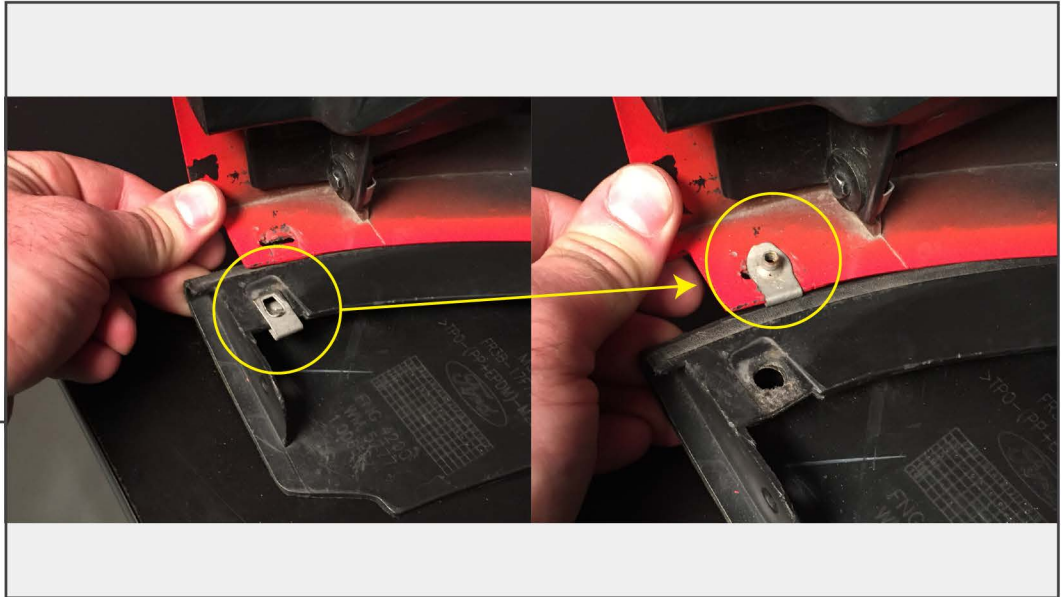

STEP 3

Transfer the screw clip from the factory chin spoiler to bumper cover, as seen above, the MMD Chin Spoiler will reuse the factory bumper holes. Rotate the clip 180 degrees, so the threaded portion is facing upward, when transferring the clip to the bumper cover. Performance-Pack equipped vehicles will have an additional support bracket attached inside the factory chin spoiler via plastic clips. Transfer the inner support bracket onto the MMD Chin Spoiler, this bracket is necessary for reinstalling the splash shield.



STEP 4

Install the GT350 Style Chin Spoiler using the factory hardware, then reinstall the factory splash shield.