

CDC Chin Splitter Install (05-09 GT)

Tools Required:

- ✓ Power drill
- ✓ ¼" bit
- ✓ Small clamps (at least 4)
- ✓ Phillips head screw driver
- ✓ Flat head screw driver or panel/fork tool

Instructions:

1. With your CDC chin spoiler installed, jack up your Mustang and put on jack stands with the parking break on.
2. Remove the Black barbed push pin on both sides of your CDC Chin Spoiler



3. Use clamps to hold the chin splitter onto the chin spoiler.



4. Align the splitter to the desired position making sure that it is centered and flush to the back if desired. There should be about 1" of the splitter on each side of the spoiler.



5. Once in position drill through the chin spoiler at the center hole using a 1/4" bit and install the plastic screw in retainer that is supplied with your splitter

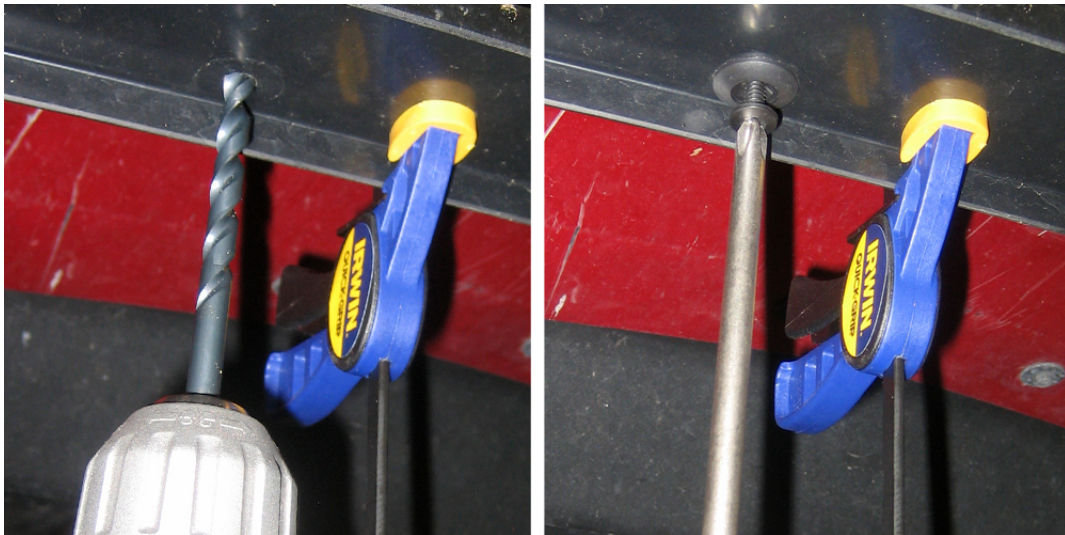

6. Continue drilling and installing the retainers through the holes in the splitter, moving outward alternating sides as you go. Move your clamps so that they are holding the splitter tight to the spoiler and do not focus on just one side of the splitter.

7. With all the screw retainers are installed it is time to install the push retainer. The provided directions stated that there was a hole already in the splitter to drill through. If the splitter has no hole locate a place on the splitter that will allow you to drill through the splitter, spoiler, and front fascia. Put clamps nearby and drill through using a 1/4" bit then push in barbed push pin provided.



8. Congratulations! You have now installed your chin splitter adding an awesome racing look you your favorite Mustang. Just remove the jack stands and lower your Mustang and you are ready to go.



Installation Instructions written by American Muscle customer Ryan McGill 7.10.14