

# Prosport Inc.

## Performance Oil Pressure Gauge

Blue/White Display (270° Scale)

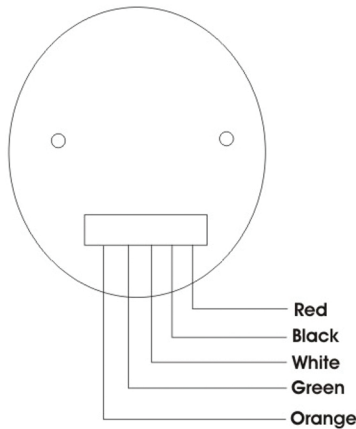

### Wiring Instructions

(White during the day, Blue at Night)

- Red- 12v Accessory power
- White- 12v Accessory power
- Black- Ground
- Orange- 12v Headlight Switched Power  
(This is a power source that only gets power when headlights are on)
- Green- Connect to "G" terminal on sender

### Sender

- "Wk" Terminal- Ground
- "G" Terminal- Attach green wire from gauge

~Optional  
Oil adapter plate sold Separate

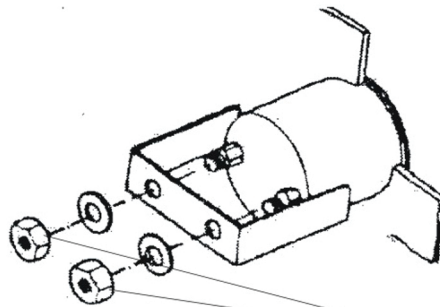
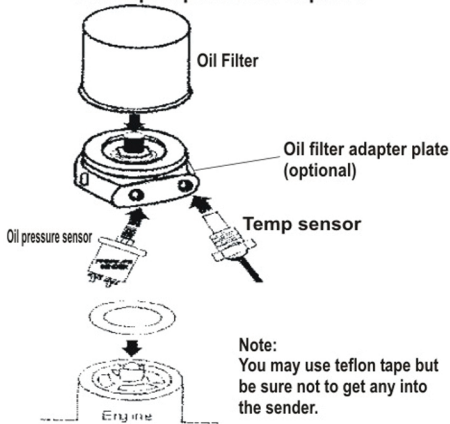

Do not over tighten bolts when installing U bracket. Doing so will cause damage to movement inside.

# Performance Oil/ Water Temperature Gauge

Blue/ White Display (270° Scale)

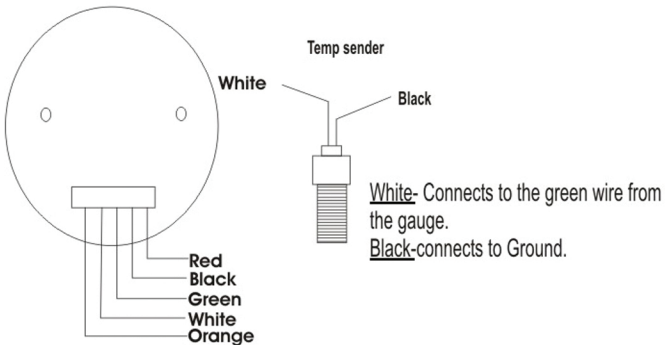

### Wiring Instructions

- Red- 12v Accessory power
- Black-Ground
- White- 12v accessory power
- Green- Temp Sensor
- Orange- Head light switch (12v Switch power)

### Lighting Options

Day Time	Night Time	Installation
White	White	White-- Connect to acc. Power
		Orange-- Do not connect
Blue	Blue	White-- Do not connect
		Orange-- Connect to acc. Power
White	Blue	White-- Connect to acc. Power
		Orange-- Connect to Headlight Switched Power
Blue	White	White-- Connect to Headlight Switched Power
		Orange-- Connect to acc. Power

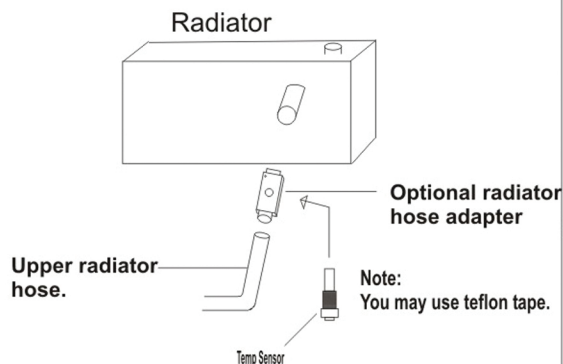

~Optional  
Oil adapter plate sold Separate

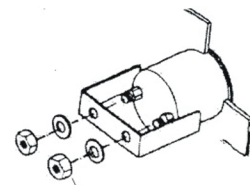
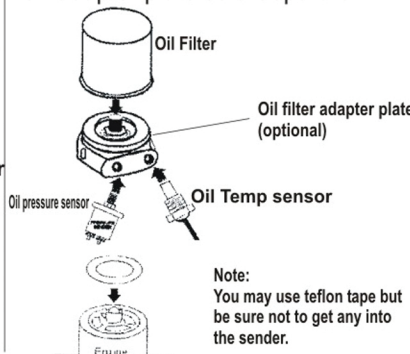

Do not over tighten bolts when installing U bracket. Doing so will cause damage to movement inside.