

1994-1998 Icon Tail Lights

CONTENTS:

- (2) - Tail Lights
- (2) - Wire Harness connector

TOOLS REQUIRED:

- Socket wrench
- 11mm socket
- small regular screwdriver
- razor blade
- electric tape



STEP 1:
Open the trunk lid and access one side of the trunk. Remove the plastic, trunk liner retainers using a small screwdriver.



STEP 2:
From inside the trunk, remove the (4) 11mm nuts from the tail light studs. Push the rubber wire grommet through the rear of the car and unplug the tail light connector. The tail light can now be removed from the car. (trunk liner has been removed from car for illustration purposes.)

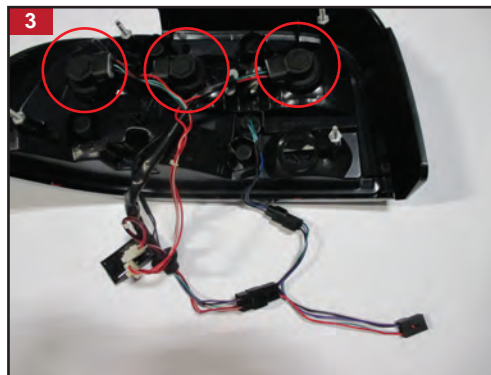

STEP 3:
Switch the bulbs and sockets from the old lights into the new lights. The reverse socket will not be reused, remove the bulb and tape it out of the way.

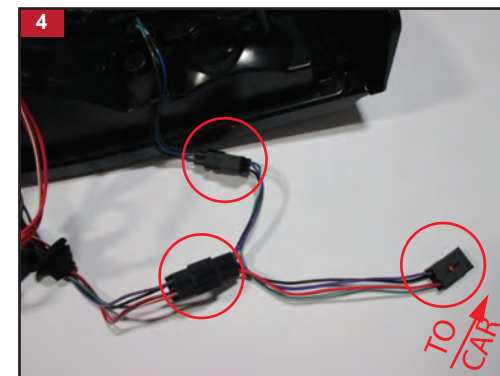

STEP 4:
Plug the supplied adapter harness into the existing light harness.



STEP 5:
Carefully remove the tape, and cut a slot in the tail light wire harness grommet. Then reattach the grommet on the adapter harness where the harness will pass through the trunk sheet metal.

STEP 6:
Care for your new tail lights by keeping them clean with spray detailer and a clean microfiber cloth. Do not use harsh solvents or buffing compounds on the lenses.



INSTALLATION GUIDE:

1994-1998 Icon Tail Lights

Item # 389876