



**IMPORTANT WARRANTY & INSTALLATION
INSTRUCTIONS ATTACHED**

*Please Forward All Attached Information to Consumer
Warranty Not Valid Unless Returned to CORSA Exhaust*

We ask that you take a few moments to complete our warranty registration form:

**TO ACTIVATE YOUR LIMITED LIFETIME WARRANTY GO TO:
CORSAPERFORMANCE.COM/WARRANTY**



**For Full-Color Installation Instructions, Please Visit:
CORSAPERFORMANCE.COM and Search by Part Number**

Please be sure to review the enclosed instructions prior to beginning the installation process. If you have any questions about the enclosed parts, instructions or encounter a problem during installation:
CALL CORSA PERFORMANCE TECHNICAL ASSISTANCE AT 800.486.0999

Please take time to read and understand these installation instructions.

CORSA recommends that the installation of this system be performed by a qualified service center or professional muffler installer who has the necessary equipment, tools and experienced personnel. However, if you decide to perform this install, the use of a hoist and an additional person will be required.

CAUTION: Never work on a hot exhaust system. Allow time for the vehicle to cool. Always wear eye protection when working under a vehicle.

Recommended Tools:

- 3/8" drive ratchet
- 3/8" drive torque wrench
- 3/8" drive 13mm socket
- 3/8" drive 15mm deep socket
- Grommet pullers
- Soap and water solution
- Torque Wrench
- Safety glasses

Please confirm that all parts are present before beginning the factory exhaust system removal and CORSA exhaust system installation.

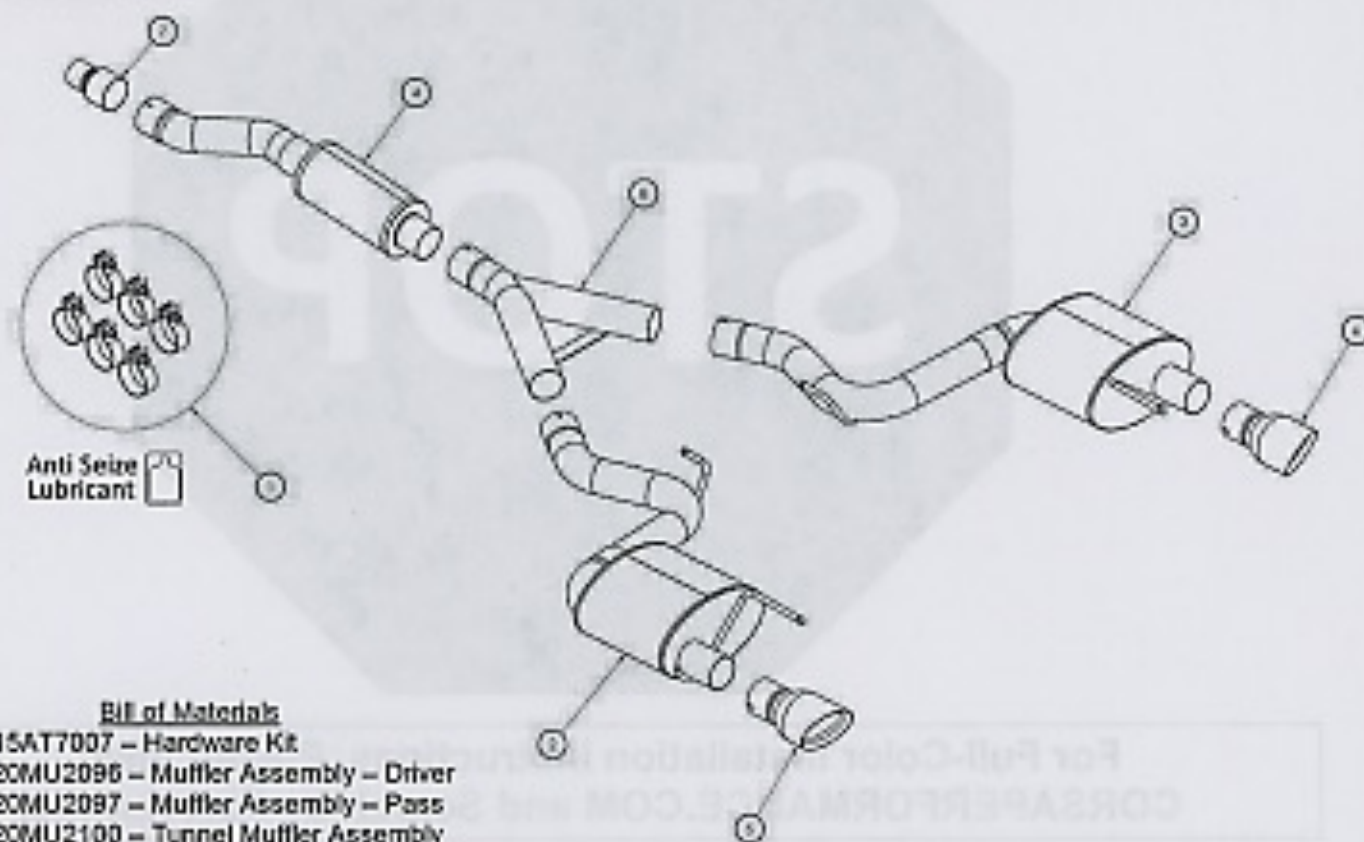

Bill of Materials

1. 15AT7007 – Hardware Kit
2. 20MU2096 – Muffler Assembly – Driver
3. 20MU2097 – Muffler Assembly – Pass
4. 20MU2100 – Tunnel Muffler Assembly
5. 20MU3010 – Tip Assembly – Driver
6. 20MU3011 – Tip Assembly – Passenger
7. 20MU4076 – Inlet to Stock Adapter
8. 20MU4120 – Y-Pipe Assembly

Factory Exhaust System Removal:

1. Using a 3/8" drive ratchet and 15mm deep socket, loosen the sleeve clamp at the cat-back connection point. Both nuts must be loosened in order for the clamp to fully disengage. (Fig. A)
2. Using the 3/8" drive ratchet and 13mm socket, remove the bolt holding down the front driver side hanger grommet assembly. (Fig. B) Once the bolt is removed, push up slightly on the exhaust and slide the hanger grommet assembly rearward to free it from the rear suspension sub-frame. Rotate the hanger grommet assembly a minimum of 90° so that it will not interfere with the rear suspension sub-frame. (Fig. C) Place the bolt in a safe location as it will be reused during the installation of the CORSA cat-back exhaust system. Repeat this process for the passenger side hanger grommet assembly.
3. Slide the stock exhaust assembly rearward until the stock resonator inlet pipe is free of the sleeve clamp. Lower the front of the exhaust in order to create clearance between the resonator inlet pipe and the sleeve clamp, then slide the complete exhaust forward to remove the rear driver and passenger side hangers from their respective hanger grommets. (Fig. D) The stock exhaust assembly will now be free from the vehicle. (Fig. E)

NOTE: The use of a soap and water solution may aid in the removal of hanger grommets.

4. Remove both the driver and passenger side hanger grommet assemblies from the front muffler hangers using grommet pullers or a similar device. (Fig. F) Set the hanger grommet assemblies aside, in a safe location, as they will be re-used for the installation of the CORSA cat back exhaust system.

NOTE: The use of a soap and water solution may aid in the removal of hanger grommets.

This concludes the factory exhaust system removal.

REMOVAL PICTURES ON NEXT PAGE



Factory Exhaust System Removal Pictures:

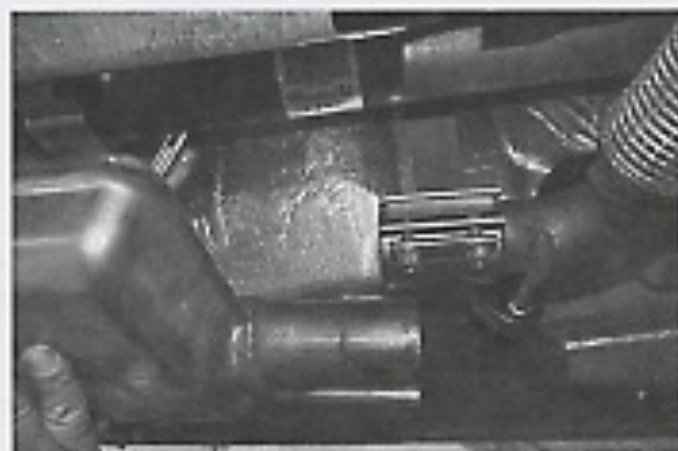

Fig. A



Fig. B



Fig. C



Fig. D

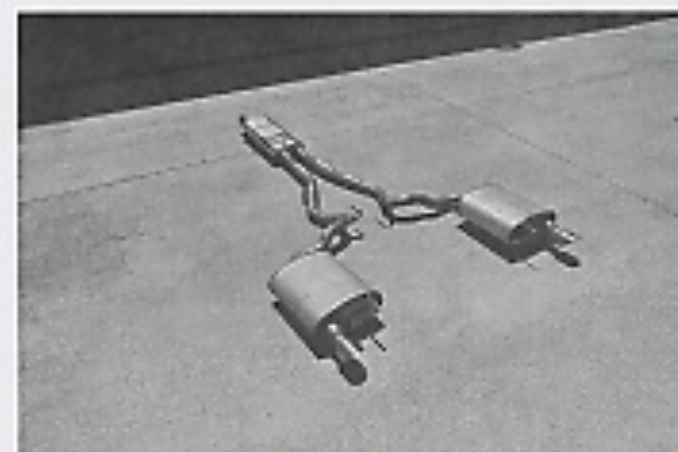

Fig. E

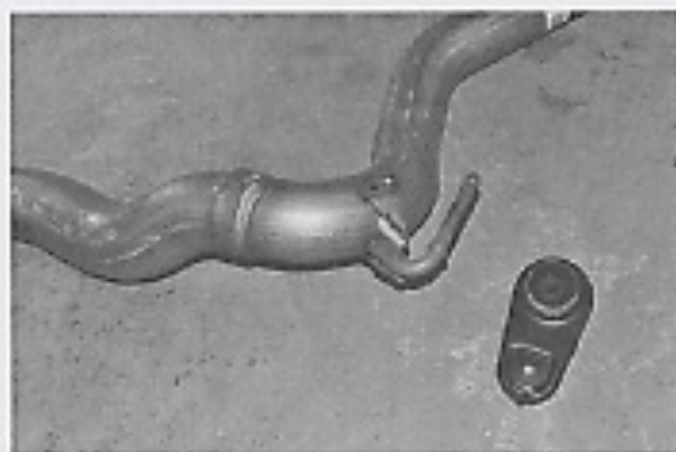

Fig. F

Installation of CORSA Exhaust System:

NOTE: Apply the anti-seize lubricant (supplied) to the threads **ONLY** of all the clamps and flange bolts. Failure to follow this procedure can cause nuts to seize on clamps and potentially destroy threads. After applying anti-seize lubricant, be sure to thoroughly clean your hands, as lubricant will tarnish stainless steel. All clamps should be tightened using a properly calibrated Torque Wrench. Using an air impact gun will damage the clamp and reduce its ability to effectively seal the joint. It may also cause the joint to separate, thereby causing damage to your exhaust system and to your vehicle.

NOTE: Align all clamps so that the center of the clamp bolt is 90 degrees from the notch in the pipe. (See Fig. CLAMP)



1. Remove all exhaust system components from the shipping boxes, including clamps and hardware.
2. Locate the cat-back inlet adapter. Slide the adapter into the factory sleeve clamp, and tighten the clamp using the ratchet and 15mm deep socket, until the adapter is snug in the clamp. (Fig. G)
3. Locate the tunnel muffler assembly and one 3" clamp. Install the clamp on the expanded inlet end of the tunnel muffler assembly so that the bolt is vertical with the nut towards the ground and the bolt towards the passenger side of the vehicle. Slide the tunnel muffler over the cat-back adapter outlet. (Fig. H) Position the tunnel muffler so that the first bend is at a slight incline towards the drive shaft. The tunnel muffler is positioned correctly when there is a 1" clearance gap between the tunnel muffler pipe and the drive shaft bushing. There should also be a 13/16" gap between the rear tunnel muffler endcap and the drive shaft. Tighten the clamp using the ratchet and 15mm deep socket until the tunnel muffler is snug on the adapter. (Fig. I)

NOTE: Place a jack stand or similar device under the tunnel muffler for support.

4. Locate the Y-Pipe assembly and one 3" clamp. Install the clamp on the expanded inlet end of the Y-Pipe assembly so that the bolt is vertical with the nut towards the ground and the bolt towards the driver side of the vehicle. Slide the Y-Pipe over the outlet end of the tunnel muffler assembly. (Fig. J) Position the Y-Pipe so that the brace is facing down and is parallel with the ground. Tighten the clamp using the ratchet and 15mm deep socket until the Y-Pipe is snug on the tunnel muffler.
5. Locate the passenger side hanger grommet assembly removed during step #4 of the stock exhaust removal process along with the passenger side muffler assembly. Install the hanger grommet assembly onto the front hanger of the muffler assembly in the same position as previously installed on the stock exhaust. (Fig. K)

NOTE: The use of a soap and water solution may aid in the installation of hanger grommets.

INSTALLATION INSTRUCTIONS CONTINUED ON NEXT PAGE

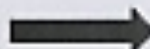

6. Locate one 3" clamp. Install the clamp on the passenger side muffler inlet pipe so that the bolt is vertical with the nut towards the ground and the bolt is towards the inside of the vehicle. (Fig. L) Slide the rear hanger into the rear hanger grommet located on the vehicle above and just inside of the passenger side tip cut out. (Fig. M) Next, slide the muffler inlet pipe over the passenger side y-pipe outlet. (Fig. N)

NOTE: The use of a soap and water solution may aid in the installation of hanger grommets.

7. Locate the 13mm bolt removed during step #2 of the stock exhaust removal process. Install the front passenger hanger grommet assembly onto the rear suspension sub-frame and tighten it down with the 13mm bolt, using the 3/8" ratchet and 13mm socket. (Fig. O)
8. Tighten the clamp connecting the passenger muffler inlet pipe to the passenger side y-pipe outlet using the ratchet and 15mm deep socket until muffler assembly is snug on the y-pipe. (Fig. P)
9. Repeat steps #4-#7 on the driver side of the vehicle. Once the system is secure, it is safe to remove the jack stand from beneath the tunnel muffler.
10. Locate the passenger rear tip assembly and one 3" clamp. Install the clamp on the tip inlet pipe so that the bolt is horizontal with the nut towards the inside of the vehicle and the bolt towards the top. Slide the tip assembly over the muffler outlet pipe and tighten the clamp using the ratchet and 15mm deep socket until the tip assembly is snug on the muffler outlet pipe. (Fig. Q & R) Repeat this process for the driver side tip assembly
11. Adjust the system accordingly, including the adapter overlap on the stock sleeve clamp, the rear muffler depth and rotation, along with the tip depth and rotation, so that the tips are centered in the bumper valance. Rotate the tips so that the CORSA etch is on top with the tip rotation matching the slanted tip cut out profile of the valance. (Fig. S & T) Check the position of all hangers to make sure they are properly seated within their corresponding grommets. Check clearances between the system components and chassis. At this time, tighten all clamps to 45ft-lbs using the torque wrench and 15mm socket.

NOTE: During cold weather start-ups, you may experience an exhaust sound that is deeper and louder in tone than usual. This is temporary and will diminish to normal levels once your engine has reached its normal operating temperature.

NOTE: Immediately following the installation of your exhaust system, you may experience a trace of smoke after initial start-up. DO NOT be alarmed. The smoke is caused by the burning of a small amount of forming oil residue used in the manufacturing process.

INSTALLATION PICTURES ON NEXT PAGE 

CORSA Installation Pictures



Fig. G



Fig. H



Fig. I

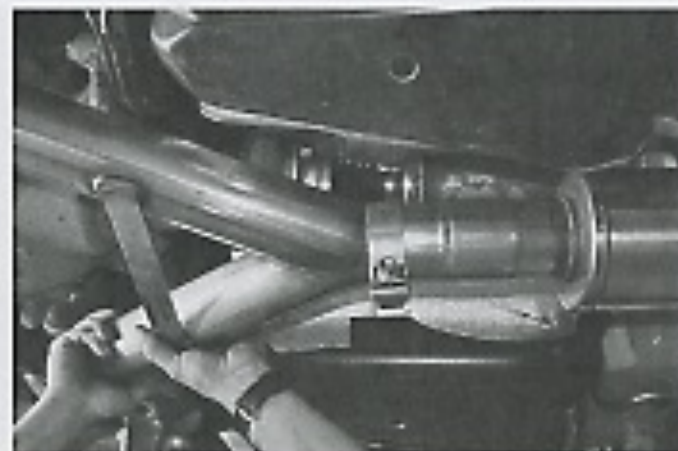

Fig. J



Fig. K

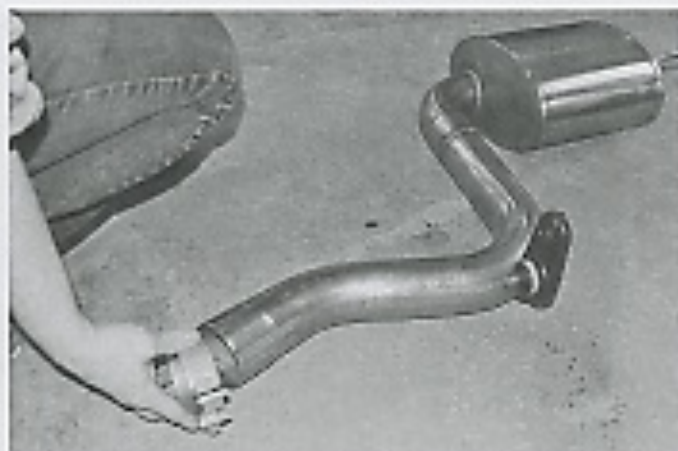

Fig. L

CORSA Installation Pictures



Fig. M

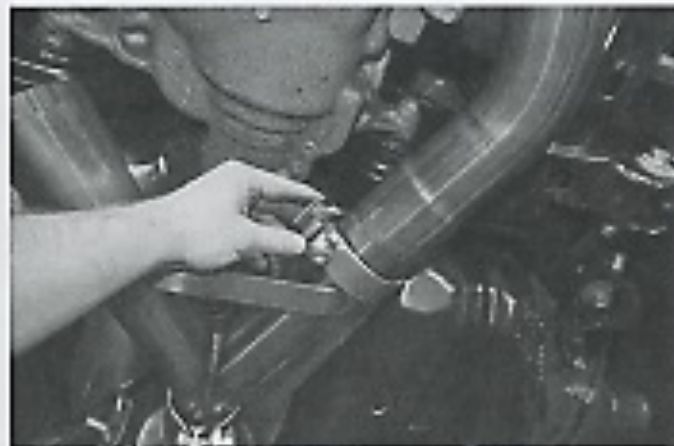

Fig. N



Fig. O



Fig. P



Fig. Q



Fig. R

CORSA Installation Pictures



Fig. 5



Fig. 7