

advanced FLOW engineering

Instruction Manual P/N: 51-12822 / 54-12822

Make: **Ford** Model: **Mustang EcoBoost** Year: **2015-2016** Engine: **I4-2.3L (t)**



- Please read the entire instruction manual before proceeding.
- Ensure all components listed are present.
- If you are missing any of the components, call customer support at 951-493-7100.
- Ensure you have all necessary tools before proceeding.
- Do not attempt to work on your vehicle when the engine is hot.
- Disconnect the negative battery terminal before proceeding.
- Retain factory parts for future use.

Label	Qty.	Description	Part Number
A1	1	Pro DRY S Air Filter	21-35508 (Gray Media)
A2	1	Pro 5R Air Filter	24-35508 (Blue Media)
B	1	Scoop	05-12822B3
C	1	Tube 1 of 2	05-12822B1
D	1	Tube 2 of 2	05-12822B2
E	1	Sleeve, Urethane	05-01390
F	1	Coupling, Silicone Hump	05-01245
G	1	Coupling, Silicone Straight	05-01106
H	1	Bracket, Aluminum	05-00744
I	3	Clamp, #048	03-50007
J	1	Clamp, #044	05-50019
K	1	Isolation Mount	03-50022
L	2	Nut, Hex: M6x1	03-50059
M	3	Washer, Flat: M6	03-50070
N	1	Washer, Flat: M12	03-50485
O	1	Screw. Hex Hd: M12x1.75x30	03-50486
P	1	Screw, Hex Hd: M6x1x20	03-50057

Tools needed: Tools needed: 8mm and 10mm nut driver or socket, flat screw driver, and T20 torx driver.

Note: Legal in California for use on race vehicles only. The use of this device on vehicles used on public streets or highways is strictly prohibited in California and others states that have adopted California emission regulations.

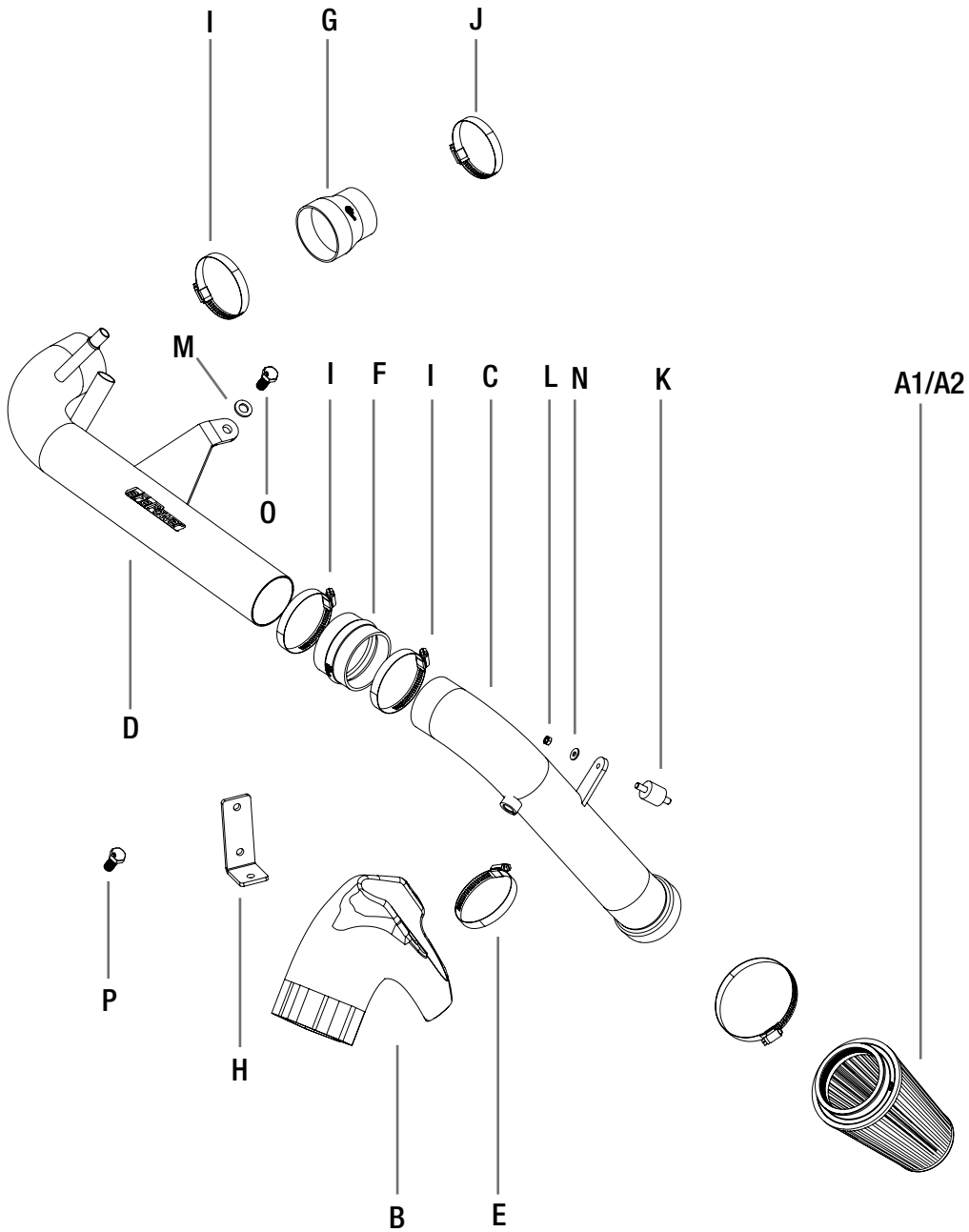

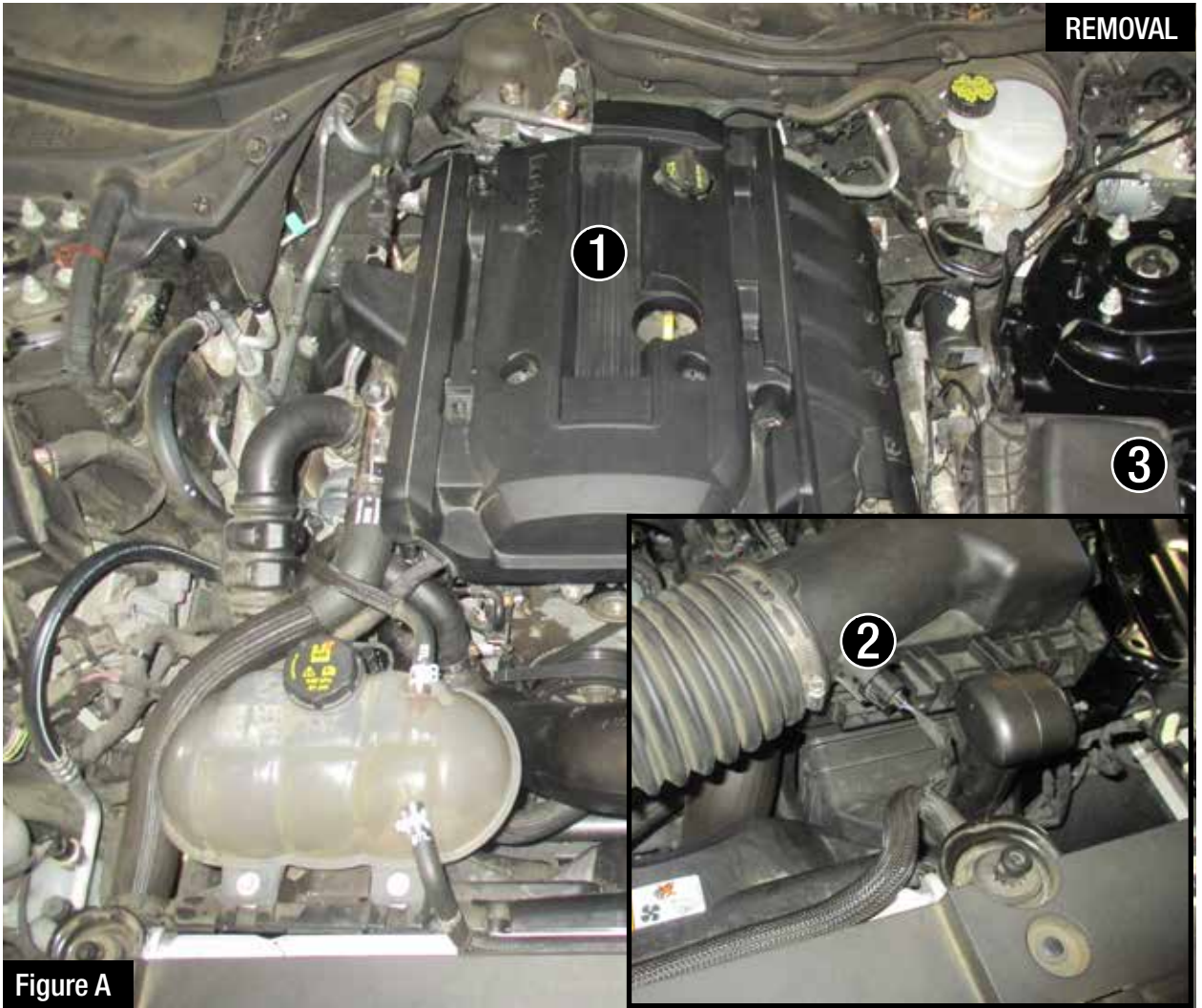

Figure A

Refer to Figure A for Steps 1-6

Step 1: Remove the engine cover (1).

Step 2: Detach the temperature sensor from the stock air box (2).

Step 3: Loosen the clamp on the recirculating hose and detach from stock intake tube, Along with crank case hose.

Step 4: Loosen the clamp on the stock intake tube connecting to the turbo with a 7mm nut driver.

Step 5: Remove the 10mm screw securing the stock air box (3).

Step 6: Remove the stock intake system by pulling it upwards out of the vehicle.



Figure B

Refer to Figure B for Step 7

Step 7: Install the aFe coupling with clamps onto the turbo inlet tube, do not tighten clamps at this time.



Figure C

Refer to Figure C for Steps 8-9

Step 8: Install the aFe tube into the coupling and with the supplied M12 bolt (4) and washer loosely secure the tube bracket to the engine and slide the hump coupling with clamps onto the end of the intake tube.

Step 9: Re-connect the crank case fitting along with the recirculating hose.

INSTALL



Figure D

Refer to Figure D for Step 10

Step 10: Remove the chassis ground bolt and replace with the supplies isolation mount (5).

REMOVAL



Figure E

Refer to Figure E for Step 11

Step 11: Remove the push clips and screws holding the driver side splash pan guard to gain access into the inner fender well and bumper (6).



Figure F

Refer to Figure F for Step 12

Step 12: To make room for the filter, relocate the horn closest to the firewall with the supplied bracket, screw, washers and nut.



Figure G

Refer to Figure G for Steps 13-17

Step 13: Open the supplied clamp and slide through the slots on the aFe air scoop.

Step 14: Install the aFe air scoop into the vehicle over the stock air intake inlet location.

Step 15: Install the filter intake tube into the vehicle in the hump coupling and isolation mount with washer and nut, do not tighten clamps and nut at this time.

Step 16: Insert the aFe urethane sleeve between the intake tube and clamp to avoid damaging the powder coat on the intake tube. Close off the clamp but do not fully tighten at this time.

Step 17: Insert the temperature sensor into the aluminum fitting, secure it by turning clockwise.

INSTALL



Figure H

Refer to Figure H for Steps 18-19

Step 18: Install the aFe filter from the bottom opening of the vehicle onto the intake tube and tighten filter clamp.

Step 19: Re-install the splash pan guard, refer to Step 11.



Figure 1

Refer to Figure 1 for Steps 20-23

Step 20: Align tubes and start tightening all clamps starting with the turbo inlet coupling along with M12 bolt and nut on isolation mount.

Step 21: Re-install the engine cover.

Step 22: Verify all clamps, screws and nuts are tight.

Step 23: your installation is now complete. Thank you for choosing aFePower!

NOTE: Check all bolts, clamps and connectors after 200 miles.

Page left blank intentionally



Pro DRY S Air Filter



P/N: 21-35508

Pro 5R Air Filter



P/N: 24-35508

Pro DRY S Restore Kit



P/N: 90-59999

Blue Squeeze Restore Kit



P/N: 90-50501

Exhaust System



P/N: 49-33084-B (Blk Tips)
49-33084-P (Pol Tips)

Twisted Steel Headers



P/N: 48-33017-HC (Street)
48-33017-HN (Race)

Coilovers



P/N: 430-301001-N

Sway Bars



P/N: 440-301001-N

Lowering Springs

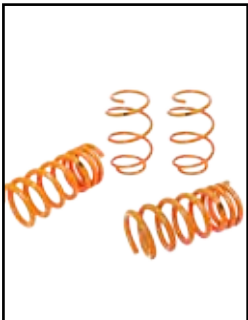

P/N: 410-301002-N

Intercooler Tubes



P/N: 46-20254-B

To purchase any of the items above, view airflow charts, dyno graphs, photos, and video; please go to aFepower.com.

Warranty

General Terms:

- aFe warrants their products to be free from manufacturer's defects due to workmanship and material.
- This warranty applies only to the original purchaser of the product and is non-transferrable.
- Proof of purchase of the aFe product is required for all warranty claims.
- Warranty is valid provided aFe instructions for installation and/or cleaning were properly followed.
- Proper maintenance with regular inspections of product is required to insure warranty coverage.
- Damage due to improper installation, abuse, unauthorized repair or alteration is not warranted.
- Incidental or consequential damages or cost, including installation and removal of part, incurred due to failure of aFe product is not covered under this warranty.
- All warranty is limited to the repair and/or replacement of the aFe part. To request Return Goods Authorization ("RGA"), email RGA@afepower.com or call (951)493-7100. Upon receipt of the RGA, you must return the product to the address provided in the RGA, freight prepaid and accompanied with a dated proof of purchase and the RGA. Upon receipt of the defective product and upon verification of proof of purchase, aFe will either repair or replace the defective product within a reasonable time, not to exceed thirty days.

Product Category	P/N Prefix	Warranty duration
Direct OE Replacement Filters	10, 11, 30, 31, 71, 73	Life of the vehicle
Racing Filters	18	1 year
Universal	21, 24, 72	2 years
Air Intake Systems	50, 51, 54, 55, 75	2 years
Exhaust Systems	49	2 years
Intercoolers & Intercooler Tubes	46-2	2 years
Intake Manifolds	46-1	2 years
Differential Cover	46-7	Life of the vehicle
Exhaust Manifolds	46	2 years
Throttle Body Spacers	46-3	2 years
Fluid Filters	44	90 days
Pre-Filters	28	2 years
Heavy Duty OE Replacement	70	2 years
PowerSports OE Replacement	81, 87	2 years
PowerSports Intake Systems	85	2 years

No other warranty expressed or implied applies nor is any person or advanced FLOW engineering authorized to assume any other warranty. Some States do not allow the exclusion or limitation of incidental or consequential damages or do not allow limitations on how long an implied warranty lasts, so the above limitations or exclusions may not apply to you. This warranty gives you specific legal rights, and you may also have other rights which vary from State to State.

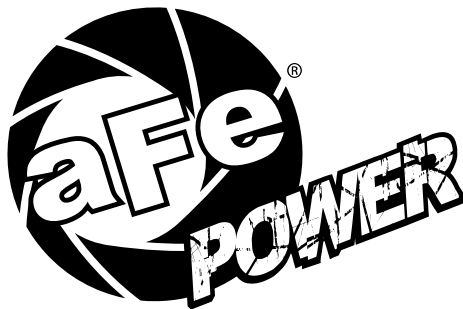

advanced FLOW engineering, inc.
252 Granite Street Corona, CA 92879
TEL: 951.493.7155 • TECH: 951.493.7100
E-Mail: Tech@aFepower.com