

2010-2013 HOOD SCOOP

Before beginning, make sure hood has been thoroughly cleaned to prevent scratching.



1

Using a trim removal tool or side cutters, carefully remove the 13 push pins securing the hood insulation pad and set it aside.



2

Use a tape measure and masking tape to mark a spot 22" in the center of the hood from the rear.

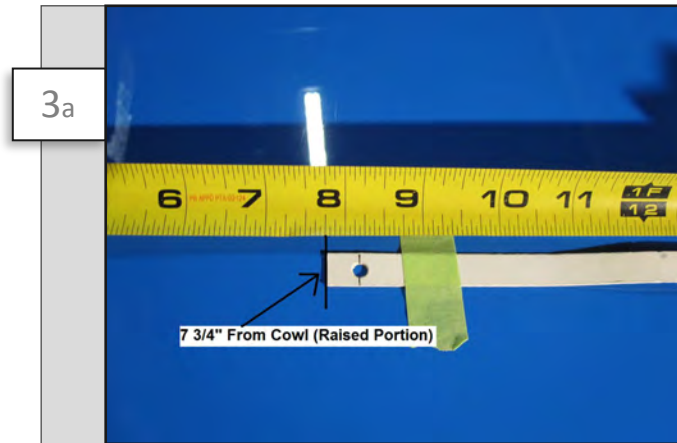

3a

Measure 7 3/4" from the edge of the cowl (raised portion of hood) on either side to center the drill template.

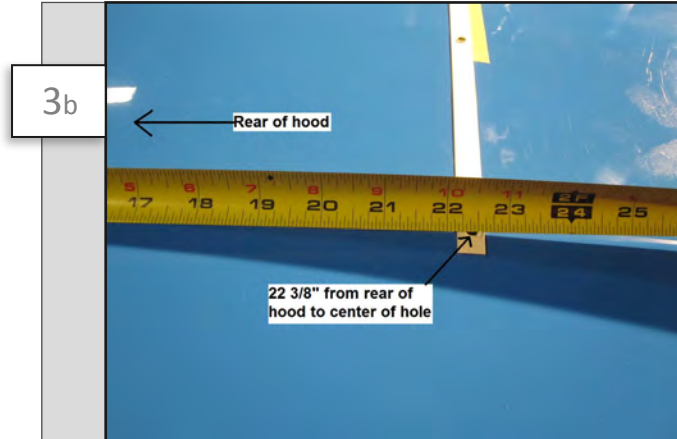

3b

Measure 22 3/8" from the rear of the hood to the center of the hole on the template to align it.

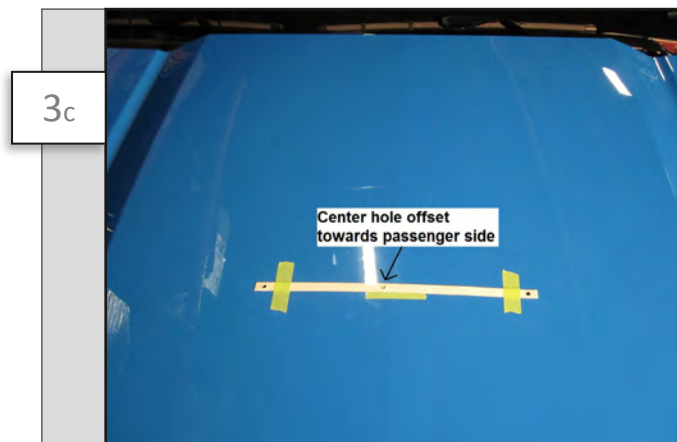

3c

Once in the correct position, tape the template to the hood as shown. **(Make sure center hole is offset towards passenger side as seen above)**

TOOLS REQUIRED

Power Drill Trim Removal Tool
Tape Measure 9mm Socket & Ratchet
3/16" Drill Bit Masking/Painters Tape

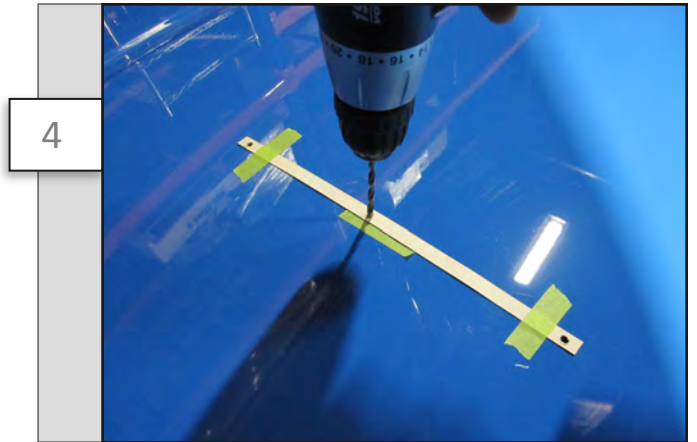

4

Using a 3/16" bit, drill 3 holes through the hood using the template as a guide. Use a shop-vac to clean up any metal shavings after drilling.

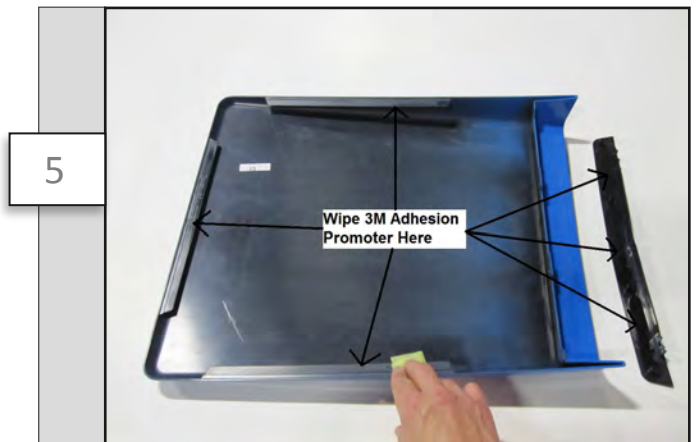

5

Lay the scoop upside down on something soft so as not to damage the finish. Wipe the supplied 3M Adhesion Promoter on the reverse side of the insert and the tabs of the scoop.



6

Apply the supplied adhesive tape to the areas wiped with Adhesion Promoter.

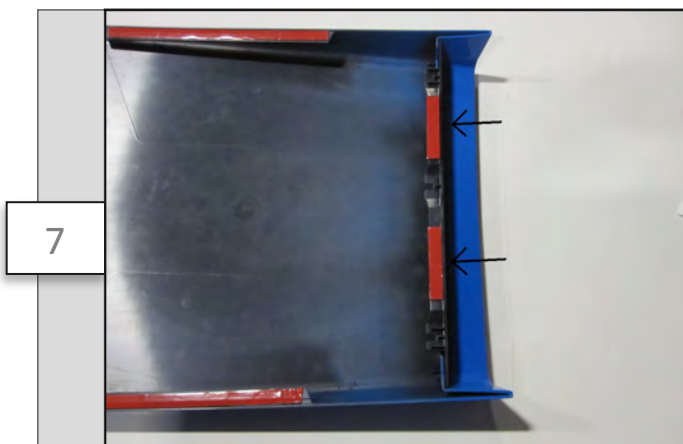

7

Remove the backing from the adhesive on the scoop's insert and install it on the front of the scoop as shown. Place the final two adhesive strips to the underside of the insert.

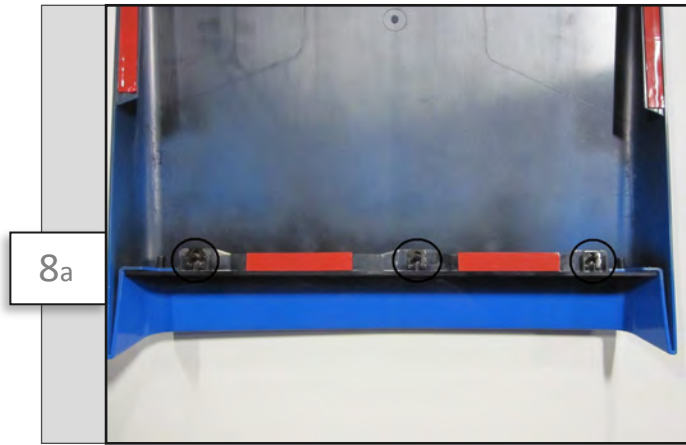

8a

Install the 3 included U-Studs on the scoop insert.



8b

If they are loose on the insert, squeeze the backside with a pair of side cutters to tighten the gap.

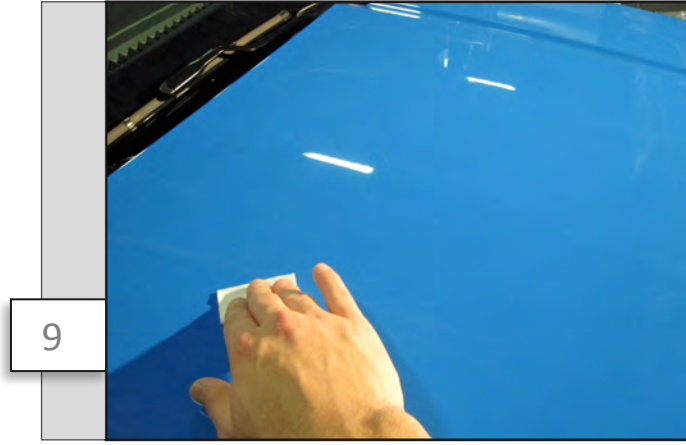

9

Thoroughly wipe the area of the hood where the scoop will be applied with the supplied alcohol pads to ensure a clean bond.

TOOLS REQUIRED

- Power Drill
- Trim Removal Tool
- Tape Measure
- 9mm Socket & Ratchet
- 3/16" Drill Bit
- Masking/Painters Tape

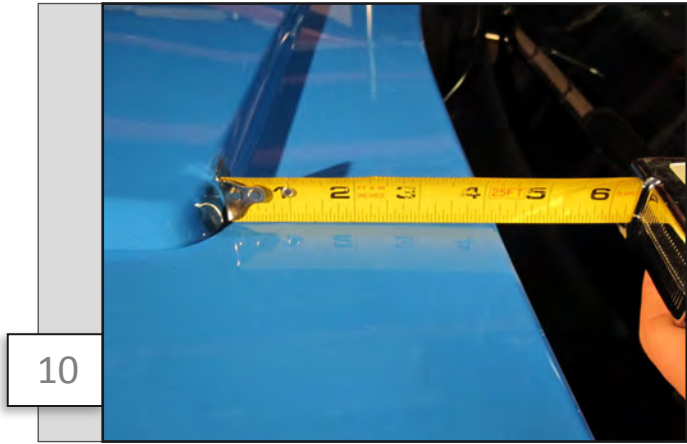

10

Remove the backing from the adhesive strips and place the scoop on the hood using the pre-drilled holes as a guide. **(DONT PRESS DOWN YET)** The scoop should sit about 4 1/4" from the rear of the hood. Once each side sits equally from the rear edge, the scoop is centered.

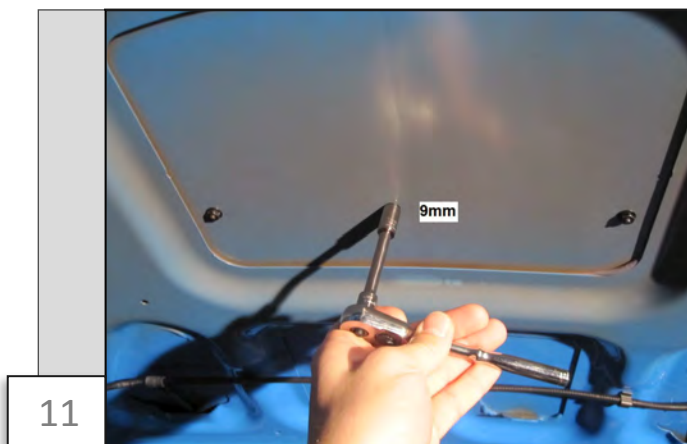

11

Once you are sure the scoop is centered, press down firmly around the edges and the front insert to fully seat the adhesive. Open the hood and install the nuts on the U-Studs. Tighten firmly with a 9mm socket.